

Layug Karen: H&F

From: noreply@lbhf.gov.uk
Sent: 19 August 2017 11:11
To: licensing
Subject: Online application

Dear Hammersmith and Fulham Licensing Team,

Your reference for this application is **2017/01101/LAPR**.

A summary of **New Premises licence** application is below:

Licence type : New Premises licence	
PREMISES DETAILS	
Premises name and address :	301 North End Road London W14 9NS
Occupier :	kasim chaudry T/A Chelsea Grill LTD
Trade As :	Chelsea Grill Ltd
Telephone number at premises :	
General description of premises :	ITS A FAST FOOD TAKEWAY. WE SELL GRILL FOOD BURGERS SOFT DRINKS ETC...
Premises rateable value :	£25000
Premises still being built :	No
APPLICANT DETAILS	
I/We apply for a premises licence under section 17 of the Licensing Act 2003 and I/We are making this application to you as the relevant licensing authority in accordance with section 12 of the Licensing Act 2003	
Applicant type :	Organisation
If a person other than an individual :	as a limited company
Company name :	CHELSEA GRILL LTD
Registered company number :	09887340
Company address :	301, North End Road, London, W14 9NS
Company telephone number :	
Company email address :	
Description of organisation :	FAST FOOD TAKEWAY.

I/We are carrying on or proposing to carry on a business which involves the use of the premises for licensable activities			
Date you wish this application to take effect : 19/08/2018			
If for a limited period, when do you want it to end? : Null			
Are you expecting 5,000 or more people to attend the premises at any one time? : No			
If you are expecting more than 5000 people please state the number : Null			
What licensable activities do you intend to carry on from the premises? :			
Activity type :		Late Night Refreshment	
Will the provision of late night refreshment take place inside, outside or both? : Both			
Standard days and timings :		Day	Start time End time
		Monday	23:00:00 01:30:00
		Tuesday	23:00:00 01:30:00
		Wednesday	23:00:00 01:30:00
		Thursday	23:00:00 01:30:00
		Friday	23:00:00 01:30:00
		Saturday	23:00:00 01:30:00
		Sunday	23:00:00 01:30:00
Please give further details :		N A	
State any seasonal variations :		N A	
Non-standard timings - Where do you intend to use the premises at different times to those listed, please specify :		N A	
<i>Designated Premises Supervisor's (DPS) details</i>			
Details of designated premises supervisor not known at this time :		Yes	

Adult entertainment or services :	n a no adult activities here.		
Hours premises are open to the public - Standard days and timings :	Day	Start time	End time
	Monday	23:00:00	01:30:00
	Tuesday	23:00:00	01:30:00
	Wednesday	23:00:00	01:30:00
	Thursday	23:00:00	01:30:00
	Friday	23:00:00	01:30:00
	Saturday	23:00:00	01:30:00
	Sunday	23:00:00	01:00:00
Hours the premises are open to the public - Seasonal variations :	N A		
Hours the premises are open to the public - Non-standard timings :	n a		
Licensing objectives - General details :	floor plan red line.pdf		
Licensing objectives - The prevention of crime and disorder :	<p>CCTV shall be working and recording correctly at all times. All images shall be stored for a minimum of 31 days. At least one member of staff on duty whilst this licence is being used shall be trained in the requirements of the Licensing Act 2003 in terms of the licensing objectives offences committed under the Act and conditions of the Premises Licence. Written records of this training shall be retained and made available to police and authorised officers of the Licensing Authority on request.</p>		
Licensing objectives - Public safety :	<p>CCTV shall be working and recording correctly at all times. All images shall be stored for a minimum of 31 days. At least one member of staff on duty whilst this licence is being used shall be trained in the requirements of the Licensing Act 2003 in terms of the licensing</p>		

Licensing objectives - The prevention of public nuisance :	Signs shall be prominently displayed inside the premises reminding patrons there are residents living nearby and instructing them to respect the neighbours and to conduct their behaviour accordingly. A responsible member of staff shall carry out proactive litter patrols outside the premises at least twice 2 throughout the premises opening hours and specifically at the end of trading hours to ensure that there is no litter associated with the premises in the immediate vicinity and any such litter found shall be collected and returned to the premises for disposal with the premises normal waste refuse collection.
Licensing objectives - The protection of children from harm :	CCTV covering areas inside and outside of the premises shall be installed and maintained to police recommendations with properly maintained log arrangements. A staff member from the premises that is conversant with the operation of the CCTV system shall be on the premises at all times that the premises are open to the public. This staff member will be able to show police or authorised officers of the Licensing Authority recent data footage with the minimum of delay when requested. This data or footage reproduction shall be almost instantaneous.
CHECKLIST AND DECLARATIONS	
I have attached a plan of the premises :	Yes
I have attached a copy of the consent form completed by the individual I wish to be premises supervisor :	No
I understand that I must now advertise my application :	Yes
I understand that if I do not comply with the above requirements my application will be rejected :	Yes
<i>Correspondence Details</i>	

Correspondence name :	Mr Kasim Chaudry
Correspondence capacity :	Applicant
Correspondence address :	301, North End Road, London, W14 9NS
Correspondence telephone number :	
Correspondence alternate telephone number :	02073845687
Correspondence email address :	
<p>IT IS AN OFFENCE, UNDER SECTION 158 OF THE LICENSING ACT 2003, TO MAKE A FALSE STATEMENT IN OR IN CONNECTION WITH THIS APPLICATION. THOSE WHO MAKE A FALSE STATEMENT MAY BE LIABLE ON SUMMARY CONVICTION TO A FINE OF ANY AMOUNT.</p> <p>IT IS AN OFFENCE UNDER SECTION 24B OF THE IMMIGRATION ACT 1971] FOR A PERSON TO WORK WHEN THEY KNOW, OR HAVE REASONABLE CAUSE TO BELIEVE, THAT THEY ARE DISQUALIFIED FROM DOING SO BY REASON OF THEIR IMMIGRATION STATUS. THOSE WHO EMPLOY AN ADULT WITHOUT LEAVE OR WHO IS SUBJECT TO CONDITIONS AS TO EMPLOYMENT WILL BE LIABLE TO A CIVIL PENALTY UNDER SECTION 15 OF THE IMMIGRATION, ASYLUM AND NATIONALITY ACT 2006 AND, PURSUANT TO SECTION 21 OF THE SAME ACT, WILL BE COMMITTING AN OFFENCE WHERE THEY DO SO IN THE KNOWLEDGE, OR WITH REASONABLE CAUSE TO BELIEVE, THAT THE EMPLOYEE IS DISQUALIFIED</p>	
SIGNATURE DETAILS	
Signatures name :	CHELSEA GRILL LTD
Capacity :	Applicant
Date :	19/08/2017
<p>I have included documents demonstrating my entitlement to work in the United Kingdom [Applicable to individual applicants only, including those in a partnership which is not a limited liability partnership] is now included onscreen and I have uploaded a document, I understand I am not entitled to be issued with a licence if I do not have the entitlement to live and work in the UK (or if I am subject to a condition preventing me from doing work relating to the carrying on of a licensable activity) and that my licence will become invalid if I cease to be entitled to live and work in the UK</p> <p>The DPS named in this application form is entitled to work in the UK (and is not subject to conditions preventing him or her from doing work relating to a licensable activity) and I have seen a copy of his or her proof of entitlement to work, if appropriate</p>	
<p>I accept the information contained in this application is correct to the best</p> <p style="text-align: right;">Yes</p>	

of my knowledge and belief, and I am authorized to make this application on behalf of all the named applicant(s) :	
PAYMENT DETAILS	
Fee :	£190
Payment reference :	Payment is yet to be processed for this application, at the time of this email.

Thank you,
Hammersmith and Fulham My Account Support
<http://www.lbhf.gov.uk/>

The information in this e-mail and any attachment(s) are intended to be confidential and may be legally privileged.

Access to and use of its content by anyone else other than the addressee(s) may be unlawful and will not be recognised by Hammersmith and Fulham Council for business purposes.

If you have received this message by mistake, please notify the sender immediately, delete it and do not copy it to anyone else.

Hammersmith and Fulham Council cannot accept any responsibility for the accuracy or completeness of this message as it has been transmitted over a public network.

Any opinions expressed in this document are those of the author and do not necessarily reflect the opinions of Hammersmith and Fulham Council. Any attachment(s) to this message has been checked for viruses, but please rely on your own virus checker and procedures.

Senders and recipients of e-mail should be aware that under the UK Data Protection and Freedom of Information legislation these contents may have to be disclosed in response to a request. All e-mail sent to or from this address will be processed by Hammersmith and Fulham Council's corporate e-mail system and may be subject to scrutiny by someone other than the addressee.

Layug Karen: H&F

Subject:

FW: Licensing Act - Premises Licence 2017/01101/LAPR

From: Kasim Chaudry

Sent: 23 August 2017 12:29

To: Stewart Tom - FH

Subject: Re: Licensing Act - Premises Licence 2017/01101/LAPR

Dear sir

I am agree with the timing schedule as you said. Do i need to re inform the council about these timings and also i have given advertise in the newspaper. Do i need to inform them ?

Regard

Kasim chaudry

Chelsea grill ltd

Sent from my iPhone

On 23 Aug 2017, at 1:04 pm, <Tom.Stewart@met.pnn.police.uk> <Tom.Stewart@met.pnn.police.uk> wrote:

Good Afternoon,

My name is Tom Stewart and I am the Police Licensing Officer for Hammersmith and Fulham.

I am writing to you in regards to your application for a Late Night Refreshment Licence for Chelsea Grill.

I have read your application and I appreciate the measures that you will put in place under your operating schedule. As I understand it you wish to serve food from 2300-0130 Monday to Saturday and 2300-0100 Sunday.

North End Road, particularly the area North of Lillie Road, is increasingly becoming a hot-spot for anti-social behaviour, especially around the hours of 2300-0200. This is causing police resources to become stretched. My concern is that allowing Late Night Refreshment to continue into the early hours of the morning will only increase this issue. That is not to say it can't be allowed if it is well managed by the licensee, with appropriate times.

The Metropolitan Police will have no formal objection to your application if you were to amend your times to 2300-0100 Monday to Saturday and 2300-0030 Sunday.

I feel that these above times will allow the Licensing Objectives to be promoted, and will have as little effect as possible on local residents.

Please let me know if you agree to these timings.

Kind Regards

Pc Tom Stewart 230FH | Hammersmith and Fulham Police Licensing Unit |

Shepherds Bush Police Station, 253 Uxbridge Road W12 7JA

Int: 742715 | Ext Telephone 020 8246 2715 | Mobile 07825098276 Email
tom.stewart@met.police.uk

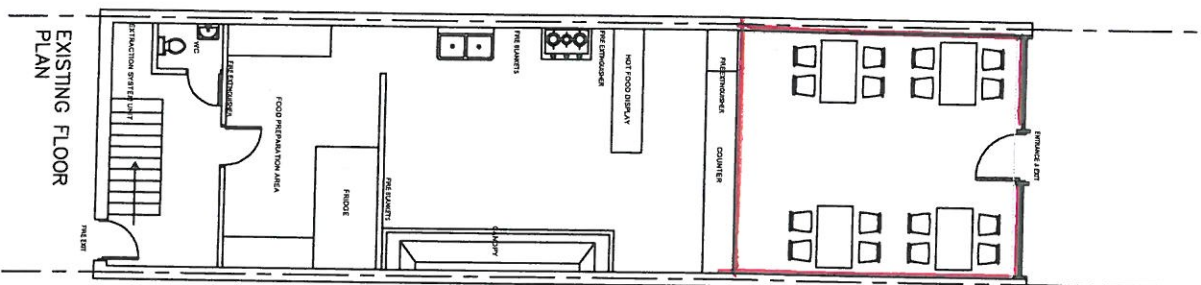

LATE NIGHT REFRESHMENT

MR KASIM

CLIENT

PROJECT
301 NORTH END ROAD,
LONDON, W14 9NS

PROJECT TITLE
INSTALLATION OF NEW
FLUE DUCT TO THE REAR

DESIGN CHART

SHEET NO.

01

DRAWING TITLE
FLOOR PLAN



DESIGN CHART LIMITED
ARCHITECTURAL DESIGNERS AND STRUCTURAL ENGINEERS
Office Suite 1, 30 Uphall Road, Ilford, Essex, IG1 2JF
Phone: 0203 5146305, Email: dgild@yahoo.co.uk

DATE
JULY
2017

NOTES
PLEASE NOTE THAT BEFORE BUILDING WORKS COMMENCE IT IS THE RESPONSIBILITY OF THE
BUILDER OR OWNER TO SERVE PARTY WALL NOTICES TO ALL NEIGHBOURS. NO CONSTRUCTION
WORK TO BE STARTED PRIOR TO COUNCIL'S APPROVAL. DRAWINGS NOT TO BE READ IN
CONJUNCTION WITH RELEVANT DRAWING AND SPECS. DRAWINGS NOT TO BE SCALED. FIGURED
IS NOT LIABLE FOR ANY FAULTS NOT RAISED. DRAWINGS NOT TO BE SCALED FOR LAND
TRANSFER PURPOSES.

London Borough of Hammersmith & Fulham

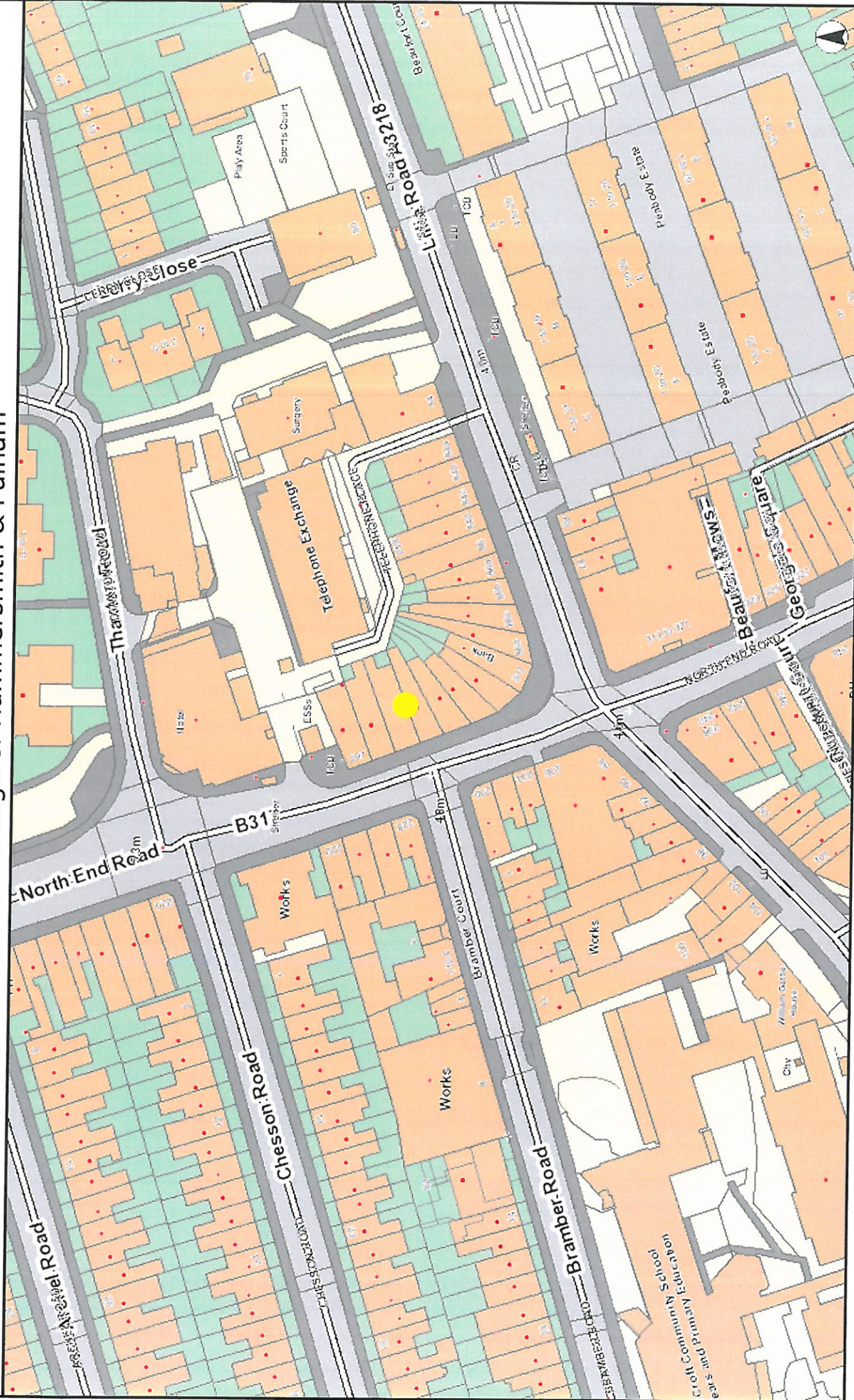

© Crown copyright and database rights 2017 OS LA100019223. © The GeoInformation Group 2017 Licence

Cities Revealed® copyright by The GeoInformation Group® and Copyright Bluesky International Ltd. 2006
Historic Maps reproduced courtesy of Landmark Information Group Ltd. All rights reserved.

Scale 1:1065

Printed on 21 Sep 2017

Memorandum

DATE: September 19, 2017

TO: Hammersmith and Fulham Licensing Team

FROM: Keith Mehaffy extension 5702

RE: Application for the grant of a premises licence at
Chelsea Grill 301 North End Road London W14 8EG.
UNIFORM Reference 2017/01101/LAPR-NEW GRANT

I am in receipt of the application for the grant of a new premises licence at the above premises. The application is for a take away premises on ground floor and requests the following licensable activity.

Late night refreshment on and off the premises Monday to Sunday 23:00 to 01:30
Opening Hours Monday to Sunday 11:00 to 01:30 hours.

My concerns in regard to this application relate to the public nuisance that may arise from cooking odours and noise from the operation of the plant at the premises, the public nuisance that could arise from customers arriving at and departing the premises up till 01:30 hours and deliveries to and from the premises during the late evening and night/ early morning period.

A recent planning permission has been granted for a new kitchen extract system at the premises and this is conditioned through a stringent noise criterion for the extract system to achieve. There are usually other pieces of plant associated with these premises, such as condenser units for the fridges and freezers. The later operation of these appliances could also impact significantly on the neighbouring residents.

The operating schedule also specified that there should be two litter patrols during the daily operation of the premises and especially at the end of the operation to remove litter associated with the premises.

The premises are located on the east side of North End Road Close to the Lillie Road junction. There are double yellow lines in the road outside the premises and a pedestrian crossing close by. Any customers who travel to the premises by car late in the evening will not be permitted to stop outside the premises and will probably have to park in the quiet side streets near the premises, where residents may have bedrooms overlooking the streets. In my view there is potential for public nuisance to be created to these residents from these customers attending the premises during the early hours and I therefore have concerns about the timing requested in the application.

It is my view that the hours should be amended to midnight Sunday to Thursday with the premises operating till 01:00 the following morning on Friday and Saturday. It is for this reason that I am making representations under the prevention of public nuisance key objective.

If the Licensing Sub-Committee are minded to grant this application, I would suggest that the hours of operation are amended as above and the following condition should be considered to address these public nuisance concerns: -

1. Signs shall be prominently displayed in the outside area reminding patrons there are residents living nearby and instructing them to respect the neighbours and to conduct their behaviour accordingly.
2. A telephone number for the premises, or a responsible member of staff on duty, shall be displayed so that it is visible from the public highway for members of the public to lodge complaints.
3. Deliveries and collections (including refuse and / or recycling collections) associated with the premises shall be arranged between the hours of 08:00 to 22:00 only. Empty bottles and non-degradable refuse shall remain in the premises at the end of trading hours and will not be taken out to the refuse point between the hours of 22:00 and 08:00 hours.
4. All plant and equipment shall be correctly installed, operated, maintained and regularly serviced, all in accordance with the manufacturer's instructions, to ensure that it is operating correctly and efficiently so as not to cause a nuisance to neighbours arising from noise.
5. All ventilation and extraction systems and ducting shall be correctly installed, operated, maintained and regularly serviced, all in accordance with the manufacturer's instructions, to ensure that they are operating correctly and efficiently so as not to cause a nuisance to neighbours arising from noise or odour.

I hope that this information is useful, please do not hesitate to contact me on the above telephone number should you wish to discuss this matter further.

Mr Keith Mehaffy

Area Senior Environmental Health Officer
Noise and Nuisance Team

Layug Karen: H&F

Subject: Re: Comments for Licensing Application 2017/01101/LAPR

From: Kasim Chaudry
Sent: 04 September 2017 14:40
To: licensing <licensing@lbhf.gov.uk>
Subject: Re: Comments for Licensing Application 2017/01101/LAPR

Dear karen

Thanks for your email.as i am on holidays thatswhy I didn't call you.

In your last email you mentioned that one of our neighbours made an objection.

Miss Elizabeth Angela Howarth talked about the litter bin which is behind the shop. Its a big commercial bin which is not possible to keep at the front of the premises.The bin is always locked. We also have contract with Viola company. They provide commercial sacs(bin bags).Which we can put at the front side of the premises at closing time and Viola will take those sacs everyday morning. 2nd issue is about the smell as she mentioned. We have already made an application in the council to change the duct pipe position . Right now we are using building chimney For duct smoke .which is bit narrow. After the duct pipe change there will not be any smell of smoke. Living above the food shop you Have smell of food sometimes. Its common. We dont have any vermin problem. Once she complained about vermin's in council. The council officer came and he didn't find any mice of other vermin in the premises. We have Pest control contract from long long time. They regularly come in the premises to treat. They also dont find any pest there. We can provide pest control contract Copy, Viola sacs contract Copy and planning application reference of duct pipe. Our customers dont come from the rear side of the premises And always keep an eye at our front side area of shop. If we find any litter we throw in the bin. We will Also Have notice in the premises for customers to leave quietly Especially at night time.

Regard

Kasim chaudry

Sent from my iPhone

From: idoxPA@hfbp.co.uk [<mailto:idoxPA@hfbp.co.uk>]
Sent: 29 August 2017 19:52
To: Layug Karen: H&F <Karen.Layug@lbhf.gov.uk>
Subject: Comments for Licensing Application 2017/01101/LAPR

Licensing Application comments have been made. A summary of the comments is provided below.

Comments were submitted at 7:52 PM on 29 Aug 2017 from Not Available.

Application Summary

Address: 301 North End Road London W14 9NS

Proposal: Licensing Act - Premises Licence

Case Officer: Karen Layug

[Click for further information](#)

Customer Details

Name: Miss Elizabeth Angela Howarth

Email:

Address: North End Road, W14 9NS

Comments Details

Commenter Type: Neighbour

Stance: Customer objects to the Licensing Application

Reasons for comment:

Comments: 7:52 PM on 29 Aug 2017 I wish to object to the application to extend the license and opening hours of Chelsea Grill. I live above this take away and already there is: litter from the take away; people (presumably customers) causing public nuisance during opening hours to the front and rear of the property; rubbish collects to the rear of the property which I have complained about multiple times; the smell of the cooking & often smoke comes into the communal areas above the shop and there have been instances of vermin - mice & cockroaches. Therefore I object to the application based on it will only increase the public nuisance as above.

Do it online at www.lbhf.gov.uk

Help us keep your council tax bill down and protect spending on vital public services - use our website to find information, view your account, make payments, apply for services and report problems.

New - create an account - Want to manage your council tax, benefits claim or parking permits online? Create an account now at www.lbhf.gov.uk/myaccount

If you have received this email in error, please delete it and tell the sender as soon as possible. You should not disclose the contents to any other person or take copies.

All emails you send over the internet are not secure unless they have been encrypted. For further details, please see: www.getsafeonline.org/protecting-yourself
